



The N1604 is a 4 megapixel IP camera with a motorized varifocal lens, wide dynamic range and built-in IR illumination. Paired with a compatible CheckVideo Gateway, this camera benefits from superb image quality during the day and night, cloud management and video analytics. It is ONVIF compatible and supports RTSP streaming for video.

FEATURES

- ✓ 1/2.8 " Progressive Scan CMOS
- ✓ 2.7-13.5mm Motorized lens
- ✓ 4MP@30fps
- ✓ Multiple Streams
- ✓ Smart IR Up to 40m
- ✓ 3D DNR,WDR,ICR

DIMENSIONS

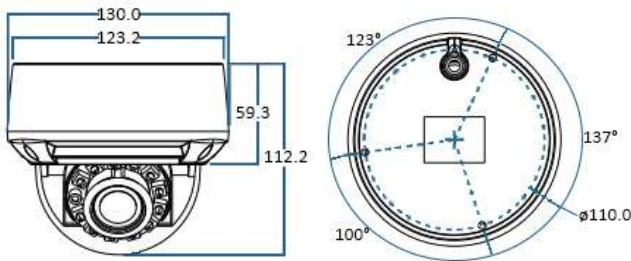

PRODUCT NUMBER

N1604	201165
-------	--------

MOUNTS

Pendant Cap	201793
Mounting Arm	201581

CAMERA	
Image Sensor	1/2.8" Progressive Scan CMOS
Min. illumination	Color :0.05Lux@(F1.2,AGC ON);B/W: 0 Lux@(IR LED ON)
Day & Night	ICR
Shutter Speed	1/5-1/20000s
Auto Iris	Fixed
Wide Dynamic Range	WDR >120dB
Digital Noise Reduction	2D/3D
Lens	2.7-13.5mm Motorized lens
FOV	103° ~ 34.3°
IR Range	Up to 130 ft
VIDEO	
Video Compression	H.265/H.264/ MJPEG
Bit Rate (CBR/VBR)	Stream1: 500Kbps ~ 12Mbps Stream2: 100Kbps ~ 6Mbps Stream3: 100Kbps ~ 3Mbps
Max. Resolution	2592x1520/30fps
Image Settings	Rotate Mode, Saturation, Brightness, Contrast, Sharpness
ROI	Yes
Defog	Yes
NETWORK	
Network Protocols:	IPv4/IPv6, APR, 802.1x,HTTP,HTTPS,TCP/IP,UDP/IP,RTSP,DHCP,NTP, RTCP/RTP, PP-PoE, SMTP, DNS, UPnP, FTP, ICMP ,IGMP, Unicast and Multicast.
Security	User security authentication, Reset, Hardware Watch Dog
System Compatibility	ONVIF
Ethernet	1 Ethernet (10/100 Base-T) RJ-45 Connector
GENERAL	
Power Supply	DC12V/POE
Power Consumption	7.5W(MAX)
Operating Temperature	Starting Temperature: -10°C ~ 50°C (14°F ~ 122°F) Working Temperature: -20°C ~ 50°C (-4°F ~ 122°F)
Operating Humidity	0% - 90% RH
Ingress Protection	IP66
Vandal Proof	IK10
Approvals	CE /FCC
Product Dimensions	130mm×112mm (5.1" x 4.4")