



The N1604 is a 4 megapixel IP camera with a motorized varifocal lens, wide dynamic range and built-in IR illumination. Paired with a compatible CheckVideo Gateway, this camera benefits from superb image quality during the day and night, cloud management and video analytics. It is ONVIF compatible and supports RTSP streaming for video.

## FEATURES

- ✓ 1/2.8 " Progressive Scan CMOS
- ✓ 2.7-13.5mm Motorized lens
- ✓ 4MP@30fps
- ✓ Multiple Streams
- ✓ Smart IR Up to 40m
- ✓ 3D DNR,WDR,ICR

## DIMENSIONS

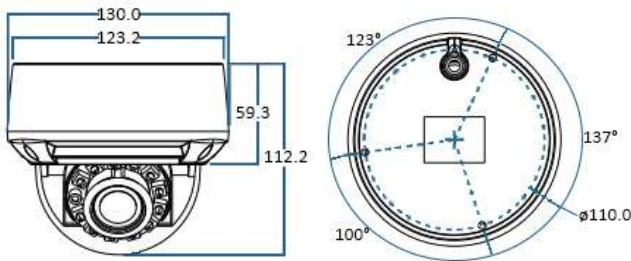

## PRODUCT NUMBER

N1604	201165
-------	--------

## MOUNTS

Pendant Cap	201793
Mounting Arm	201581

CAMERA	
Image Sensor	1/2.8" Progressive Scan CMOS
Min. illumination	Color :0.2Lux@(F1.2,AGC ON);B/W: 0 Lux@(IR LED ON)
Day & Night	ICR
Shutter Speed	1/5-1/20000s
Auto Iris	Fixed
Wide Dynamic Range	WDR >120dB
Digital Noise Reduction	2D/3D
Lens	2.7-13.5mm Motorized lens
FOV	103° ~ 34.3°
IR Range	Up to 130 ft
VIDEO	
Video Compression	H.265/H.264/ MJPEG
Bit Rate (CBR/VBR)	Stream1: 500Kbps ~ 12Mbps Stream2: 100Kbps ~ 6Mbps Stream3: 100Kbps ~ 3Mbps
Max. Resolution	2592x1520/30fps
Image Settings	Rotate Mode, Saturation, Brightness, Contrast, Sharpness
ROI	Yes
Defog	Yes
NETWORK	
Network Protocols:	IPv4/IPv6, APR, 802.1x,HTTP,HTTPS,TCP/IP,UDP/IP,RTSP,DHCP,NTP, RTCP/RTP, PP-PoE, SMTP, DNS, UPnP, FTP, ICMP ,IGMP, Unicast and Multicast.
Security	User security authentication, Reset, Hardware Watch Dog
System Compatibility	ONVIF
Ethernet	1 Ethernet (10/100 Base-T) RJ-45 Connector
GENERAL	
Power Supply	DC12V/POE
Power Consumption	7.5W(MAX)
Operating Temperature	Starting Temperature: -10°C ~ 50°C (14°F ~ 122°F) Working Temperature: -20°C ~ 50°C (-4°F ~ 122°F)
Operating Humidity	0% - 90% RH
Ingress Protection	IP66
Vandal Proof	IK10
Approvals	CE /FCC
Product Dimensions	130mm×112mm (5.1" x 4.4")